

HYDRAONE

5 IN 1 WATER SYSTEM UNIT

SPECIFICATION SHEET

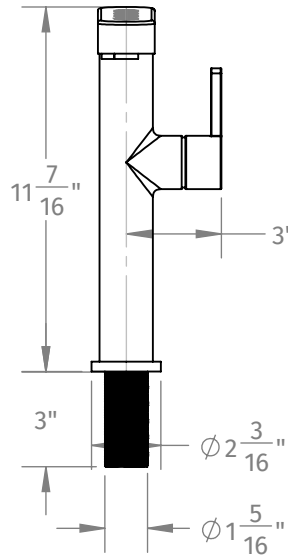
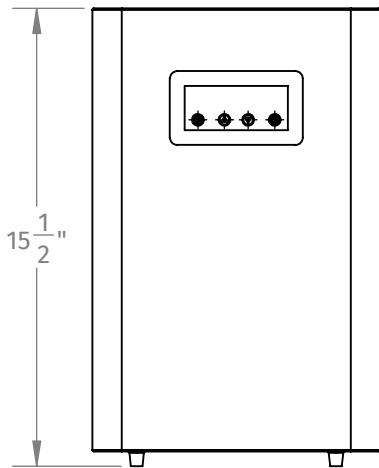

- **Touch Screen Interactive Control for Ambient, Hot, Cold and Sparkling Water**
- **Lever Controlled Domestic Water**
- **27" Power Cable**
- **Two 30-1/2" Braided Hose for Water Supply**
- **One 30-1/2" Braided Hose for Hot Tank**

System Specifications

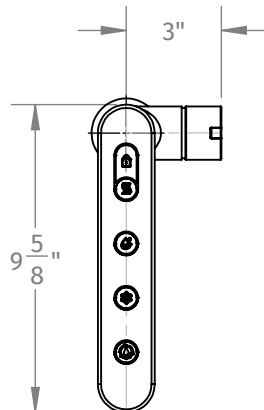
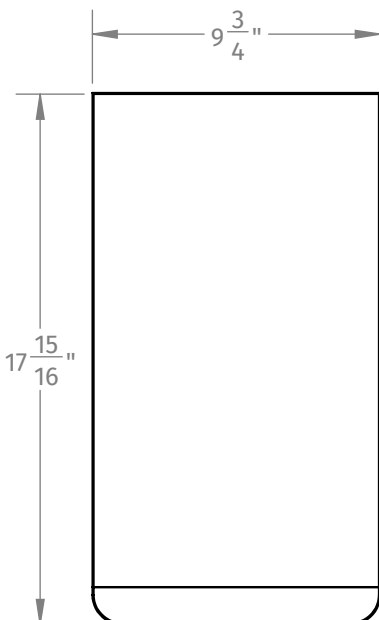

Hot Water - Temperature Range	167°F (75°C) - 208°F (98°C)
Chilled Water - Temperature Range	36°F (2°C) - 86°F (30°C)
Hot Water Capacity	5/8 Gallon (2.37 Liters)
Cold Water Capacity	5/8 Gallon (2.37 Liters)
Unit Power Rating	110 V, 60Hz, Max 1500W
Heating Element	1500W- 13.6Amps
Cooling Compressor	115W- 1.6Amps
Max Flow Rate	1.61 GPM (6.1L/min)
Max CO ₂ Pressure	60 psi (4.48bar)

WARRANTY

FOR WARRANTY INFO PLEASE VISIT WWW.MOUNTAINPLUMBING.COM/PAGE/RESOURCES/WARRANTY

FINISH CARE & MAINTENANCE

NEVER USE ANY HARSH ALKALI, ACID BASED DETERGENTS OR CLEANERS SUCH AS SOFT SCRUB®, SCRUBBING BUBBLES® OR COMET® TO CLEAN. DO NOT USE BRILLO® OR SCOTCH BRITE® PADS. THESE WILL ALL HARM THE FINISH. TO CLEAN, USE ONLY A DAMP SOFT CLOTH AND WIPE GENTLY. STANDARD WINDEX® CAN ALSO BE USED SPARINGLY. IT IS NOT NECESSARY TO WIPE HARD TO REMOVE SPOTS. TO MAINTAIN THE FINISH, WIPE WITH A SOFT DRY CLOTH AFTER USE. AN OCCASIONAL COAT OF PURE CARNAUBA WAX WITHOUT CLEANERS WILL HELP PROTECT THE FINISH.

SPECIFICATIONS SUBJECT TO CHANGE WITHOUT NOTICE