

# HYDRAONE

## 5 IN 1 WATER UNIT SYSTEM

### Equipment Provided

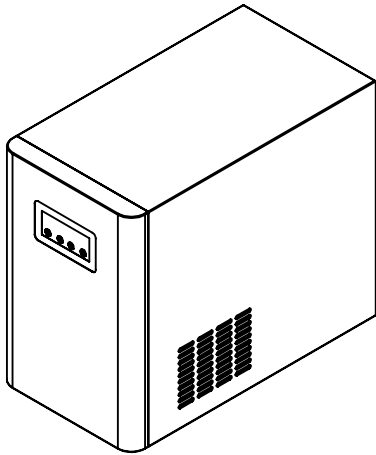

**Unit**

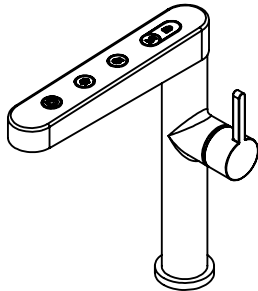

**Faucet**

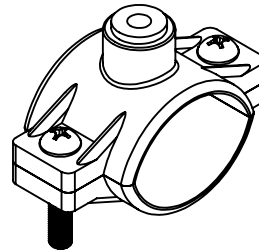

**Saddle**

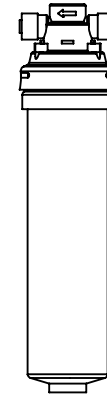

**MT1250XL**

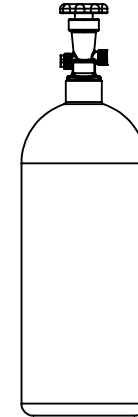

**5LBS CO2 Tank**

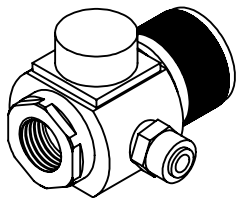

**Pressure Regulator**

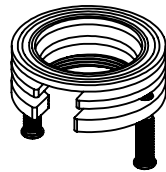

**Faucet Mounting  
Assembly**

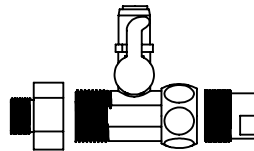

**Tee Stop Valve  
W/Adapters**

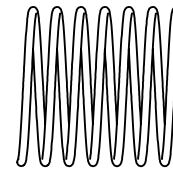

**8-1/2 Feet of 1/4" Tubing**

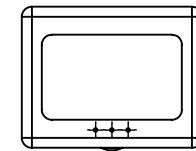

**Leak Detector**

#### **WARRANTY**

FOR WARRANTY INFO PLEASE VISIT [WWW.MOUNTAINPLUMBING.COM/PAGE/RESOURCES/WARRANTY](http://WWW.MOUNTAINPLUMBING.COM/PAGE/RESOURCES/WARRANTY)

#### **FINISH CARE & MAINTENANCE**

NEVER USE ANY HARSH ALKALI, ACID BASED DETERGENTS OR CLEANERS SUCH AS SOFT SCRUB®, SCRUBBING BUBBLES® OR COMET® TO CLEAN. DO NOT USE BRILLO® OR SCOTCH BRITE® PADS. THESE WILL ALL HARM THE FINISH. TO CLEAN, USE ONLY A DAMP SOFT CLOTH AND WIPE GENTLY. STANDARD WINDEX® CAN ALSO BE USED SPARINGLY. IT IS NOT NECESSARY TO WIPE HARD TO REMOVE SPOTS. TO MAINTAIN THE FINISH, WIPE WITH A SOFT DRY CLOTH AFTER USE. AN OCCASIONAL COAT OF PURE CARNAUBA WAX WITHOUT CLEANERS WILL HELP PROTECT THE FINISH.

SPECIFICATIONS SUBJECT TO CHANGE WITHOUT NOTICE  
[www.mountainplumbing.com](http://www.mountainplumbing.com) 972-456-3273 fax 972-456-2719

# HYDRAONE

## 5 IN 1 WATER UNIT SYSTEM

### Instructions

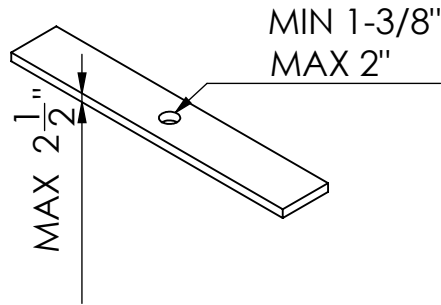

1. ENSURE THERE IS A HOLE ON COUNTER IS BETWEEN 1-3/8" AND 2" IN DIAMETER AND LESS THAN 2-1/2" IN DEPTH FOR PROPER FITMENT FOR FAUCET.

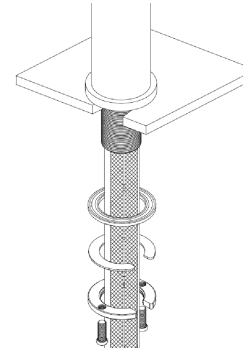

3. INSERT FAUCET SHANK THROUGH COUNTER HOLE AND SLIDE CONNECTIONS COMING FROM THE BOTTOM OF THE FAUCET THROUGH GASKET, METAL RING AND SECURE RING AND SECURE FAUCET ON COUNTER WITH SCREWS.

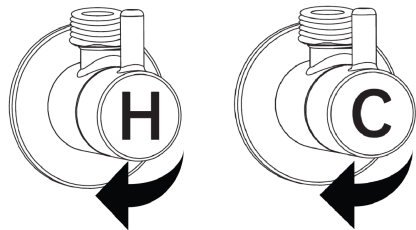

2. TURN OFF ALL WATER UNDERNEATH COUNTER AND ENSURE THERE IS FREE SPACE FOR THE MAIN UNIT TO PLACED WHERE THE UNIT'S GRILL ON THE RIGHT IS NOT BLOCKED.

3/8" Compression End Adapters

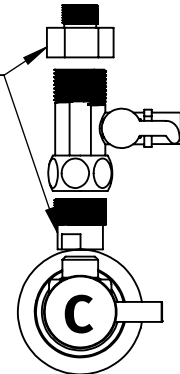

4. INSTALL AND DO NOT OVERTIGHTEN TEE STOP VALVE PROVIDED TO COLD STOP (USE ADDITIONAL ADAPTERS GIVEN FOR ENDS IF WATER STOP HAS 3/8" COMPRESSION THREAD)

#### WARRANTY

FOR WARRANTY INFO PLEASE VISIT [WWW.MOUNTAINPLUMBING.COM/PAGE/RESOURCES/WARRANTY](http://WWW.MOUNTAINPLUMBING.COM/PAGE/RESOURCES/WARRANTY)

#### FINISH CARE & MAINTENANCE

NEVER USE ANY HARSH ALKALI, ACID BASED DETERGENTS OR CLEANERS SUCH AS SOFT SCRUB®, SCRUBBING BUBBLES® OR COMET® TO CLEAN. DO NOT USE BRILLO® OR SCOTCH BRITE® PADS. THESE WILL ALL HARM THE FINISH. TO CLEAN, USE ONLY A DAMP SOFT CLOTH AND WIPE GENTLY. STANDARD WINDEX® CAN ALSO BE USED SPARINGLY. IT IS NOT NECESSARY TO WIPE HARD TO REMOVE SPOTS. TO MAINTAIN THE FINISH, WIPE WITH A SOFT DRY CLOTH AFTER USE. AN OCCASIONAL COAT OF PURE CARNAUBA WAX WITHOUT CLEANERS WILL HELP PROTECT THE FINISH.

SPECIFICATIONS SUBJECT TO CHANGE WITHOUT NOTICE  
[www.mountainplumbing.com](http://www.mountainplumbing.com) 972-456-3273 fax 972-456-2719

# HYDRAONE

## 5 IN 1 WATER UNIT SYSTEM

### Instructions

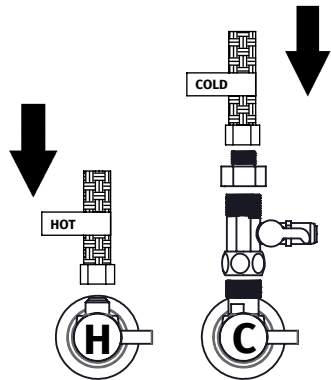

5. ATTACH AND SECURE (DO NOT OVER TIGHTEN) BOTH HOT AND COLD LABELED HOSES COMING FROM THE MOUNTED FAUCET TO WATER STOPS.

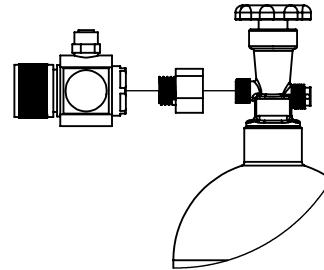

7. ATTACH CGA ADAPTOR (TO FIT USA STANDARD CO2 TANKS) AND PRESSURE REGULATOR TO CO2 TANK TO HAVE IT READY TO ATTACH 1/4" TUBING

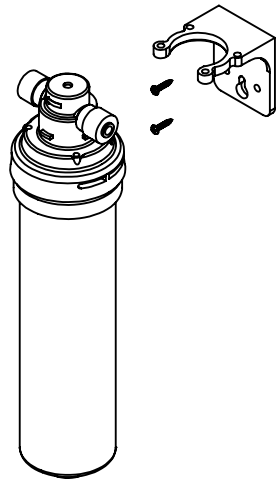

6. MOUNT MT1250XL FILTER BY INSERTING TWO SCREWS AT PERFERED LOCATION AND CLIPPING ON MOUNT. THEN ATTACH FILTER TO MOUNT TO HAVE IT READY TO APPLY 1/4" TUBING

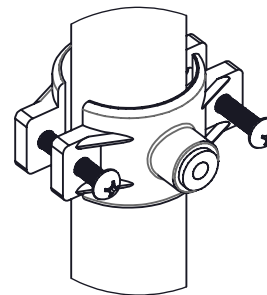

8. FIND LOCATION ON DRAIN PIPE ON WHERE TO INSTALL SADDLE AND DRILL A 1/4" HOLE AND PROCEED TO SECURE SADDLE OVER IT WITH SCREWS TO HAVE IT READY TO APPLY 1/4" TUBING

#### WARRANTY

FOR WARRANTY INFO PLEASE VISIT [WWW.MOUNTAINPLUMBING.COM/PAGE/RESOURCES/WARRANTY](http://WWW.MOUNTAINPLUMBING.COM/PAGE/RESOURCES/WARRANTY)

#### FINISH CARE & MAINTENANCE

NEVER USE ANY HARSH ALKALI, ACID BASED DETERGENTS OR CLEANERS SUCH AS SOFT SCRUB®, SCRUBBING BUBBLES® OR COMET® TO CLEAN. DO NOT USE BRILLO® OR SCOTCH BRITE® PADS. THESE WILL ALL HARM THE FINISH. TO CLEAN, USE ONLY A DAMP SOFT CLOTH AND WIPE GENTLY. STANDARD WINDEX® CAN ALSO BE USED SPARINGLY. IT IS NOT NECESSARY TO WIPE HARD TO REMOVE SPOTS. TO MAINTAIN THE FINISH, WIPE WITH A SOFT DRY CLOTH AFTER USE. AN OCCASIONAL COAT OF PURE CARNAUBA WAX WITHOUT CLEANERS WILL HELP PROTECT THE FINISH.

SPECIFICATIONS SUBJECT TO CHANGE WITHOUT NOTICE  
[www.mountainplumbing.com](http://www.mountainplumbing.com) 972-456-3273 fax 972-456-2719

# HYDRAONE

## 5 IN 1 WATER UNIT SYSTEM

### Instructions

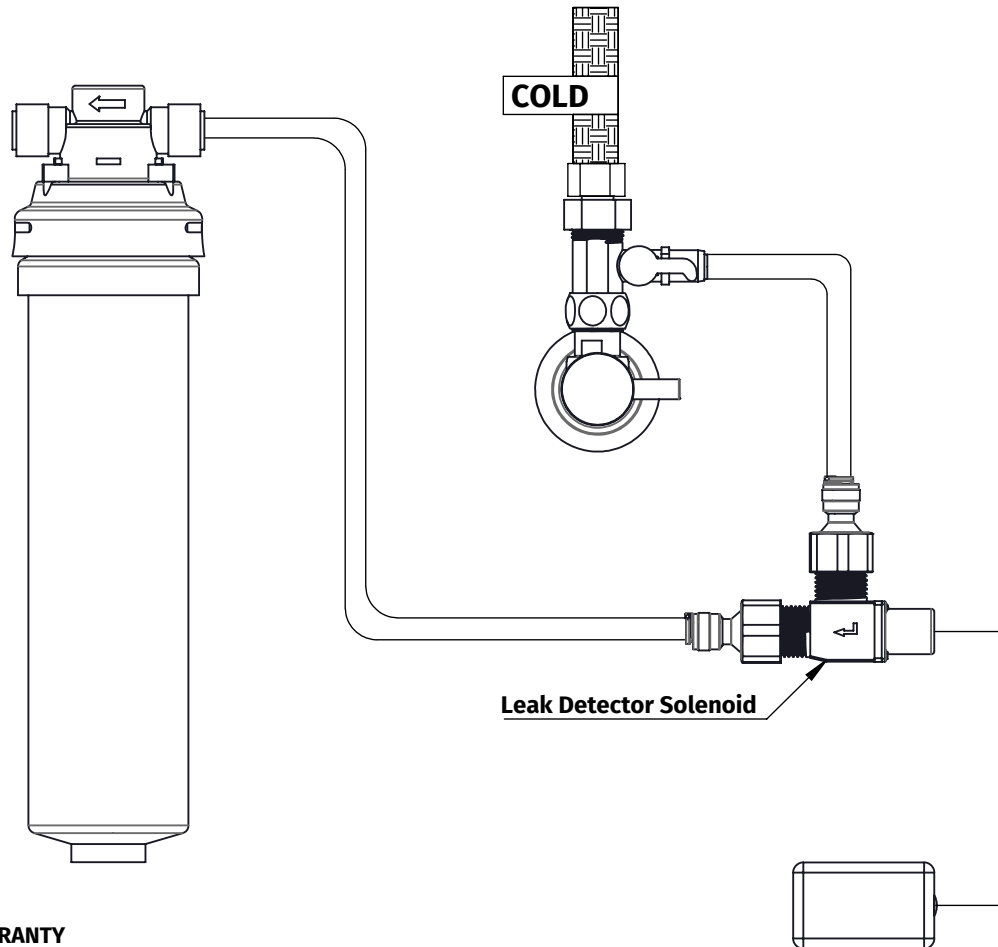

9. LOCATE 1/4" TUBING PROVIDED AND ATTACH ONE END TO THE TEE VALVE. LOCATE THE LEAK DETECTOR SOLENOID AND CUT PERFERED LENGTH CREATE A CONNECTION BETWEEN THE VALVE AND SOLENOID. THEN PLACE LEAK DETECTOR BOX ON THE COUNTER FLOOR TO BE READY TO DETECT LEAKS.

10. USING THE REST OF THE 1/4" TUBING, CREATE A CONNECTION BETWEEN THE SOLENOID OUTLET AND THE FILTER INLET

#### **WARRANTY**

FOR WARRANTY INFO PLEASE VISIT [WWW.MOUNTAINPLUMBING.COM/PAGE/RESOURCES/WARRANTY](http://WWW.MOUNTAINPLUMBING.COM/PAGE/RESOURCES/WARRANTY)

#### **FINISH CARE & MAINTENANCE**

NEVER USE ANY HARSH ALKALI, ACID BASED DETERGENTS OR CLEANERS SUCH AS SOFT SCRUB®, SCRUBBING BUBBLES® OR COMET® TO CLEAN. DO NOT USE BRILLO® OR SCOTCH BRITE® PADS. THESE WILL ALL HARM THE FINISH. TO CLEAN, USE ONLY A DAMP SOFT CLOTH AND WIPE GENTLY. STANDARD WINDEX® CAN ALSO BE USED SPARINGLY. IT IS NOT NECESSARY TO WIPE HARD TO REMOVE SPOTS. TO MAINTAIN THE FINISH, WIPE WITH A SOFT DRY CLOTH AFTER USE. AN OCCASIONAL COAT OF PURE CARNAUBA WAX WITHOUT CLEANERS WILL HELP PORTECT THE FINISH.

SPECIFICATIONS SUBJECT TO CHANGE WITHOUT NOTICE  
[www.mountainplumbing.com](http://www.mountainplumbing.com) 972-456-3273 fax 972-456-2719

# HYDRAONE

## 5 IN 1 WATER UNIT SYSTEM

### Instructions

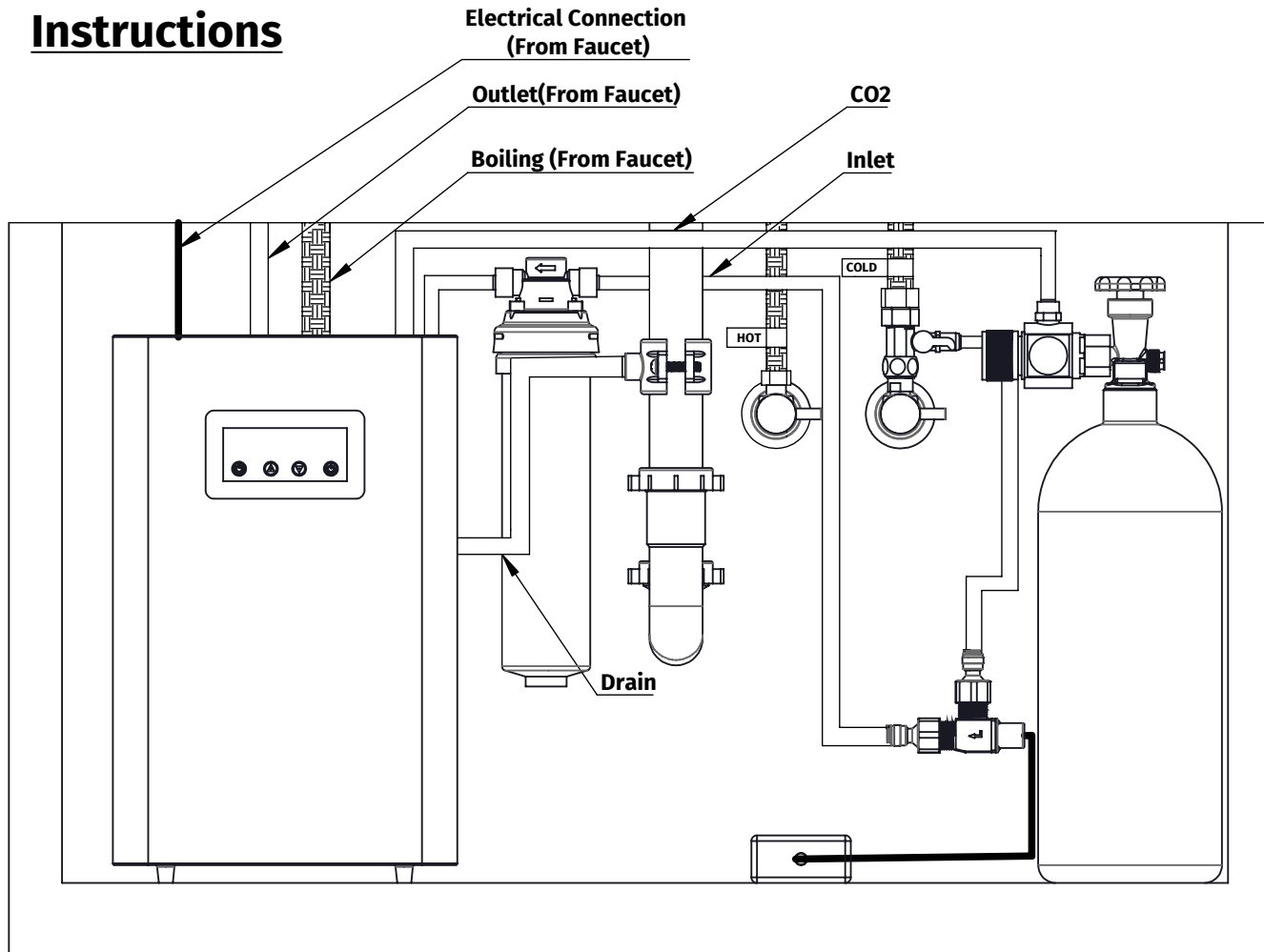

11. NOW THAT ALL OTHER COMPONENTS ARE SET UP, BRING IN MAIN HYDRAONE UNIT AND MAKE ALL 1/4" TUBE LABELED CONNECTIONS AS SHOWN IN THE DIAGRAM TO THE LEFT.

12. IN ADDITION TO ALL THE 1/4" TUBING CONNECTIONS, AN ELECTRICAL CONNECTION AND A BRAIDED HOSE (LABELED BOILING) WILL ALSO BE ATTACHED TO THE UNIT.

#### WARRANTY

FOR WARRANTY INFO PLEASE VISIT [WWW.MOUNTAINPLUMBING.COM/PAGE/RESOURCES/WARRANTY](http://WWW.MOUNTAINPLUMBING.COM/PAGE/RESOURCES/WARRANTY)

#### FINISH CARE & MAINTENANCE

NEVER USE ANY HARSH ALKALI, ACID BASED DETERGENTS OR CLEANERS SUCH AS SOFT SCRUB®, SCRUBBING BUBBLES® OR COMET® TO CLEAN. DO NOT USE BRILLO® OR SCOTCH BRITE® PADS. THESE WILL ALL HARM THE FINISH. TO CLEAN, USE ONLY A DAMP SOFT CLOTH AND WIPE GENTLY. STANDARD WINDEX® CAN ALSO BE USED SPARINGLY. IT IS NOT NECESSARY TO WIPE HARD TO REMOVE SPOTS. TO MAINTAIN THE FINISH, WIPE WITH A SOFT DRY CLOTH AFTER USE. AN OCCASIONAL COAT OF PURE CARNAUBA WAX WITHOUT CLEANERS WILL HELP PROTECT THE FINISH.

SPECIFICATIONS SUBJECT TO CHANGE WITHOUT NOTICE  
[www.mountainplumbing.com](http://www.mountainplumbing.com) 972-456-3273 fax 972-456-2719

# HYDRAONE

## 5 IN 1 WATER UNIT SYSTEM

### Instructions



13. AFTER MAKING ALL THE CONNECTIONS, PROCEED TO TURN HOT AND COLD WATER STOPS ON AND CHECK FOR LEAKS.

14. ONCE CONFIRMED THERE IS NO LEAKS, PROCEED WITH PLUGGING IN UNIT TO OUTLET.

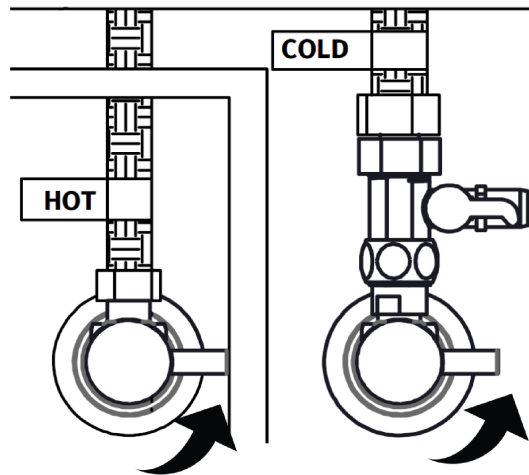

15. ENSURE UNIT AND FAUCET ARE RECEIVING POWER. THE UNIT WOULD LIGHT UP AUTOMATICALLY AND THE FAUCET BUTTONS WOULD LIGHT UP WHEN TOUCHING THE TOP SURFACE.

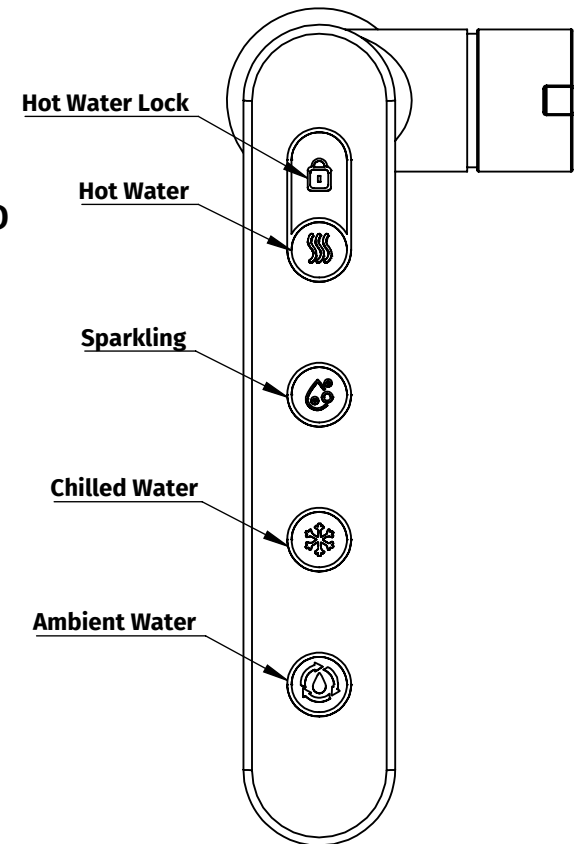

#### WARRANTY

FOR WARRANTY INFO PLEASE VISIT [WWW.MOUNTAINPLUMBING.COM/PAGE/RESOURCES/WARRANTY](http://WWW.MOUNTAINPLUMBING.COM/PAGE/RESOURCES/WARRANTY)

#### FINISH CARE & MAINTENANCE

NEVER USE ANY HARSH ALKALI, ACID BASED DETERGENTS OR CLEANERS SUCH AS SOFT SCRUB®, SCRUBBING BUBBLES® OR COMET® TO CLEAN. DO NOT USE BRILLO® OR SCOTCH BRITE® PADS. THESE WILL ALL HARM THE FINISH. TO CLEAN, USE ONLY A DAMP SOFT CLOTH AND WIPE GENTLY. STANDARD WINDEX® CAN ALSO BE USED SPARINGLY. IT IS NOT NECESSARY TO WIPE HARD TO REMOVE SPOTS. TO MAINTAIN THE FINISH, WIPE WITH A SOFT DRY CLOTH AFTER USE. AN OCCASIONAL COAT OF PURE CARNAUBA WAX WITHOUT CLEANERS WILL HELP PROTECT THE FINISH.

SPECIFICATIONS SUBJECT TO CHANGE WITHOUT NOTICE  
[www.mountainplumbing.com](http://www.mountainplumbing.com) 972-456-3273 fax 972-456-2719

# HYDRAONE

## 5 IN 1 WATER UNIT SYSTEM

### Instructions

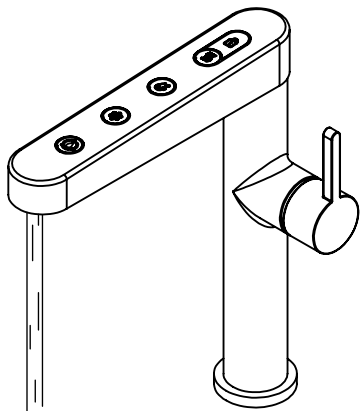

16. BEFORE PRESSING THE POWER BUTTONS ON THE UNIT, FILL UP THE HOT TANK BY PRESSING THE LOCK BUTTON ON THE FAUCET FOR UNTIL IT BEEPS AND THEN TAPPING ON THE HOT WATER BUTTON. WAIT FOR WATER TO START TO COMING OUT TO INDICATE HOT TANK IS FILLED. THEN TAP ON THE HOT WATER BUTTON AGAIN TO STOP FLOW OF WATER.

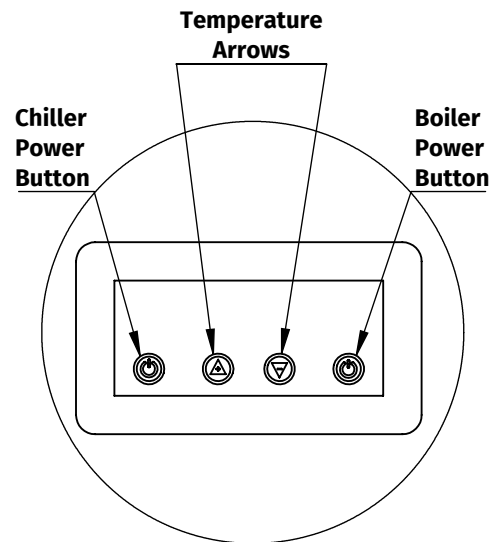

17. POWER ON HOT AND COLD WATER FUNCTIONS ON UNIT BY PRESSING THE POWER BUTTONS.

18. ADJUST TO PERFERED TEMPERATURE BY TAPING THE POWER BUTTTON OF THE HOT OR COLD SIDE. ONCE POWER BUTTON IS BLINKING, USE UP AND DOWN ARROWS TO ADJUST TEMERATURE.

**ATTENTION: IF HOT WATER FLOW RATE IS TOO HIGH, USE TEE STOP VALVE INSTALLED IN STEP 4 TO ADJUST TO A SAFE FLOW RATE!**

#### **WARRANTY**

FOR WARRANTY INFO PLEASE VISIT [WWW.MOUNTAINPLUMBING.COM/PAGE/RESOURCES/WARRANTY](http://WWW.MOUNTAINPLUMBING.COM/PAGE/RESOURCES/WARRANTY)

#### **FINISH CARE & MAINTENANCE**

NEVER USE ANY HARSH ALKALI, ACID BASED DETERGENTS OR CLEANERS SUCH AS SOFT SCRUB®, SCRUBBING BUBBLES® OR COMET® TO CLEAN. DO NOT USE BRILLO® OR SCOTCH BRITE® PADS. THESE WILL ALL HARM THE FINISH. TO CLEAN, USE ONLY A DAMP SOFT CLOTH AND WIPE GENTLY. STANDARD WINDEX® CAN ALSO BE USED SPARINGLY. IT IS NOT NECESSARY TO WIPE HARD TO REMOVE SPOTS. TO MAINTAIN THE FINISH, WIPE WITH A SOFT DRY CLOTH AFTER USE. AN OCCASIONAL COAT OF PURE CARNAUBA WAX WITHOUT CLEANERS WILL HELP PORTECT THE FINISH.

SPECIFICATIONS SUBJECT TO CHANGE WITHOUT NOTICE  
[www.mountainplumbing.com](http://www.mountainplumbing.com) 972-456-3273 fax 972-456-2719

# HYDRAONE

## 5 IN 1 WATER UNIT SYSTEM

### Instructions

NOTE: FOR OPTIMUM CARBONATION, DO NOT USE THE CARBONATION FUNCTION FOR 24 HOURS FOR THE GAS TO DISSOLVE IN WATER AND FOR THE WATER CHILL.

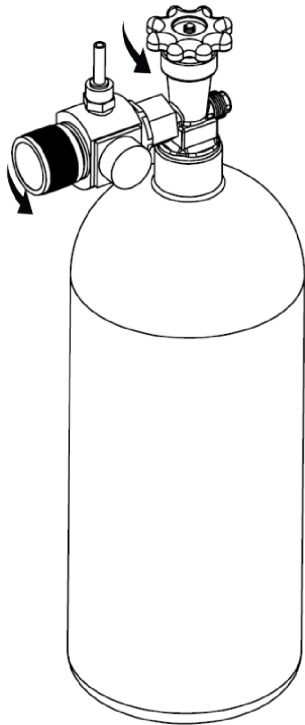

19. PROCEED WITH OPENING CO2 TANK VALVE AND THEN SLOWLY USE KNOB ON PRESSURE REGULATOR TO INCREASE PRESSURE TO 25PSI. (ENSURE PRESSURE DOES NOT GO OVER 60PSI)

20. ON THE FAUCET, TAP THE CARBONATED WATER BUTTON AND LET IT RUN FOR ABOUT 5 SECONDS. THE UNIT WILL AUTOMATICALLY TAKE IN CO2 FROM THE TANK. THE PRESSURE ON THE REGULATOR SHOULD INCREASE SLIGHTLY AFTER STOPPING THE WATER FLOW (ENSURE IT DOES NOT GO OVER 60PSI).

21. ONCE THE PRESSURE HAS INCREASED, ADJUST IT TO THE RECOMMENDED GAUGE PRESSURE BELOW BASED ON THE ALTITUDE OF YOUR LOCATION. (GOOGLE ZIP CODE ALTITUDE)

Altitude (ft.)	Recommended Gauge Pressure (psi)
Sea Level	32.8
1000	33.3
2000	33.8
3000	34.3
4000	34.8
5000	35.3
6000	35.8
7000	36.2
8000	36.6
9000	37
10000	37.4

#### WARRANTY

FOR WARRANTY INFO PLEASE VISIT [WWW.MOUNTAINPLUMBING.COM/PAGE/RESOURCES/WARRANTY](http://WWW.MOUNTAINPLUMBING.COM/PAGE/RESOURCES/WARRANTY)

#### FINISH CARE & MAINTENANCE

NEVER USE ANY HARSH ALKALI, ACID BASED DETERGENTS OR CLEANERS SUCH AS SOFT SCRUB®, SCRUBBING BUBBLES® OR COMET® TO CLEAN. DO NOT USE BRILLO® OR SCOTCH BRITE® PADS. THESE WILL ALL HARM THE FINISH. TO CLEAN, USE ONLY A DAMP SOFT CLOTH AND WIPE GENTLY. STANDARD WINDEX® CAN ALSO BE USED SPARINGLY. IT IS NOT NECESSARY TO WIPE HARD TO REMOVE SPOTS. TO MAINTAIN THE FINISH, WIPE WITH A SOFT DRY CLOTH AFTER USE. AN OCCASIONAL COAT OF PURE CARNAUBA WAX WITHOUT CLEANERS WILL HELP PROTECT THE FINISH.

SPECIFICATIONS SUBJECT TO CHANGE WITHOUT NOTICE  
[www.mountainplumbing.com](http://www.mountainplumbing.com) 972-456-3273 fax 972-456-2719

# HYDRAONE

## 5 IN 1 WATER UNIT SYSTEM

### Instructions

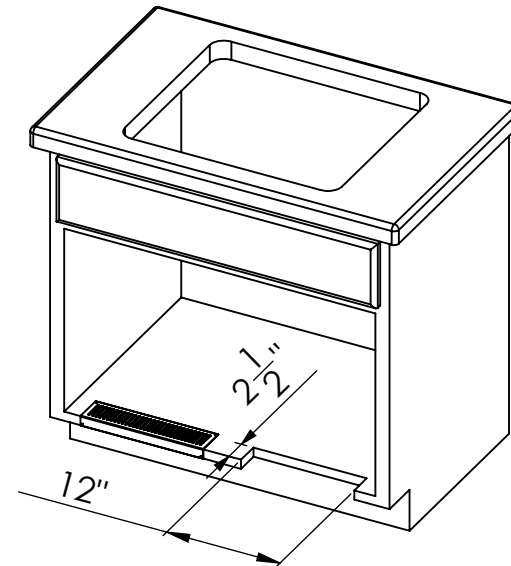
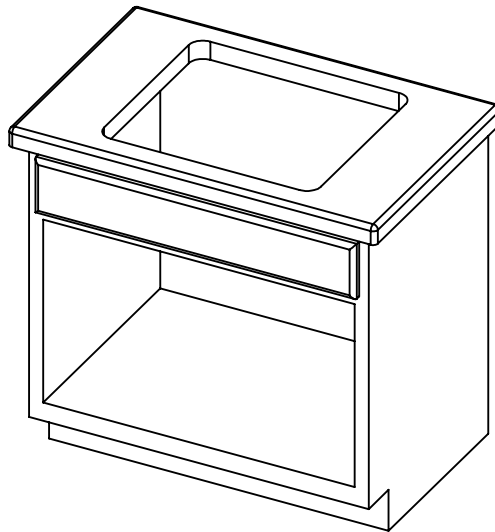

**1. TO PREVENT OVERHEATING OF UNIT, IT IS RECOMENDED TO CUT OUT ONE OR TWO 12" X 2-1/2" SECTIONS ON COUNTER FOR AIRFLOW. CUT ON ANY SIDE OF THE COUNTER WHERE THERE IS ENOUGH SPACE FOR PROPER AIRFLOW.**

**2. APPLY VENTS PROVIDED TO COVER SECTION.**

#### **WARRANTY**

FOR WARRANTY INFO PLEASE VISIT [WWW.MOUNTAINPLUMBING.COM/PAGE/RESOURCES/WARRANTY](http://WWW.MOUNTAINPLUMBING.COM/PAGE/RESOURCES/WARRANTY)

#### **FINISH CARE & MAINTENANCE**

NEVER USE ANY HARSH ALKALI, ACID BASED DETERGENTS OR CLEANERS SUCH AS SOFT SCRUB®, SCRUBBING BUBBLES® OR COMET® TO CLEAN. DO NOT USE BRILLO® OR SCOTCH BRITE® PADS. THESE WILL ALL HARM THE FINISH. TO CLEAN, USE ONLY A DAMP SOFT CLOTH AND WIPE GENTLY. STANDARD WINDEX® CAN ALSO BE USED SPARINGLY. IT IS NOT NECESSARY TO WIPE HARD TO REMOVE SPOTS. TO MAINTAIN THE FINISH, WIPE WITH A SOFT DRY CLOTH AFTER USE. AN OCCASIONAL COAT OF PURE CARNAUBA WAX WITHOUT CLEANERS WILL HELP PORTECT THE FINISH.

SPECIFICATIONS SUBJECT TO CHANGE WITHOUT NOTICE  
[www.mountainplumbing.com](http://www.mountainplumbing.com) 972-456-3273 fax 972-456-2719

# HYDRAONE

## 5 IN 1 WATER UNIT SYSTEM

### Maintenance

NOTE: A TIMER FOR FILTER CHANGE CAN BE SET UP INTERNALLY WITH IN THE UNIT

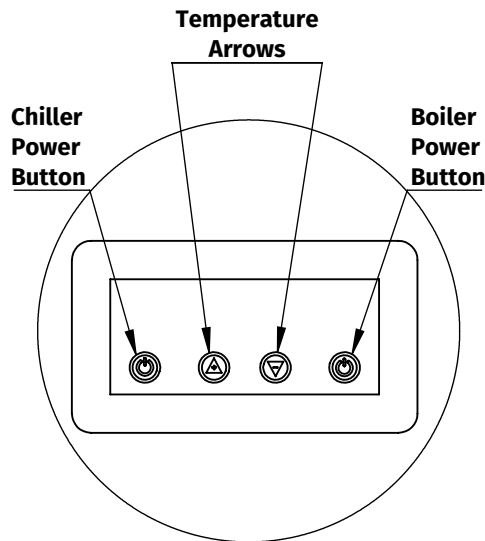

1. HOLD DOWN THE UP AND DOWN ARROWS UNTIL "F1 ##" APPEARS. (THE "F1" WOULD BE THE SPECIFIED PRESET NUMBER AND THE TWO DIGITS TO RIGHT ARE THE LIFETIME OF THE FILTER IN MONTHS)

2. PRESS THE POWER BUTTON AGAIN TWICE TO CAUSE THE TWO DIGITS ON THE RIGHT SIDE OF THE SCREEN TO BLINK.

3. USE ARROWS TO SELECT THE NUMBER OF MONTHS THE FILTER WOULD BE IN NEED OF REPLACEMENT.

Orange Filter Indicator Light

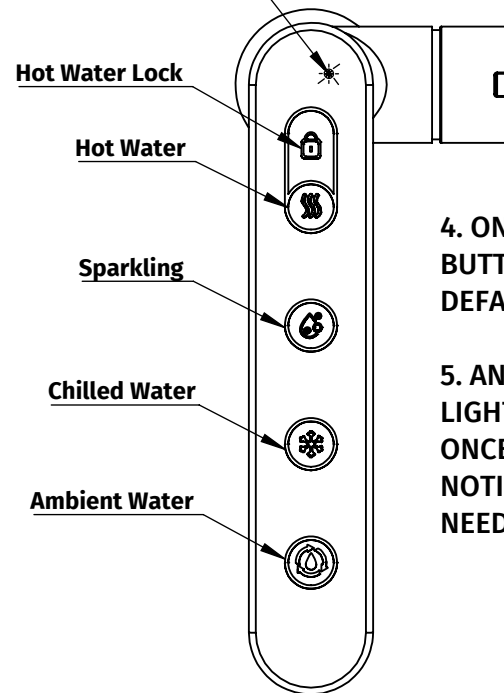

4. ONCE SET, PRESS THE POWER BUTTON AGAIN TO RETURN TO DEFAULT TEMPERATURE DISPLAY.

5. AN ORANGE INDICATOR WILL LIGHT UP ON THE FAUCET DISPLAY ONCE THE TIMER IS DONE TO NOTIFY THAT A FILTER CHANGE IS NEEDED.

#### WARRANTY

FOR WARRANTY INFO PLEASE VISIT [WWW.MOUNTAINPLUMBING.COM/PAGE/RESOURCES/WARRANTY](http://WWW.MOUNTAINPLUMBING.COM/PAGE/RESOURCES/WARRANTY)

#### FINISH CARE & MAINTENANCE

NEVER USE ANY HARSH ALKALI, ACID BASED DETERGENTS OR CLEANERS SUCH AS SOFT SCRUB®, SCRUBBING BUBBLES® OR COMET® TO CLEAN. DO NOT USE BRILLO® OR SCOTCH BRITE® PADS. THESE WILL ALL HARM THE FINISH. TO CLEAN, USE ONLY A DAMP SOFT CLOTH AND WIPE GENTLY. STANDARD WINDEX® CAN ALSO BE USED SPARINGLY. IT IS NOT NECESSARY TO WIPE HARD TO REMOVE SPOTS. TO MAINTAIN THE FINISH, WIPE WITH A SOFT DRY CLOTH AFTER USE. AN OCCASIONAL COAT OF PURE CARNAUBA WAX WITHOUT CLEANERS WILL HELP PROTECT THE FINISH.

SPECIFICATIONS SUBJECT TO CHANGE WITHOUT NOTICE  
[www.mountainplumbing.com](http://www.mountainplumbing.com) 972-456-3273 fax 972-456-2719