

MT6LD

SAFETY VALVE - LEAK DETECTOR

SPECIFICATION SHEET

FEATURES:

- PROTECTS AGAINST WATER DAMAGE, EVEN IF NOBODY IS HOME
- AUTOMATICALLY SHUTS OFF WATER SUPPLY AND SOUNDS ALARM WHEN LEAK IS DETECTED
- USES 9V ALKALINE BATTERY (INCLUDED)
- QUICK CONNECT 3/8" ADAPTERS INCLUDED
- AUTOMATICALLY SOUNDS ALARM AND SHUTS OFF WATER IF BATTERY IS LOW
- ESTIMATED BATTERY LIFE: 2 YEARS



SPECIFICATIONS:

VOLTAGE	9V DC
CURRENT	1.0 mA TYPICAL, 15.0 mA MAX
CABLE LENGTH	60"
CONNECTORS	1/2" BSP (3/8" PUSH FIT ADAPTERS)
ENVIRONMENT TEMPERATURE	33 - 176 °F
MAX PRESSURE	87 PSI
VALVE BODY MATERIAL	POM (POLYOXYMETHYLENE)
VALVE MECHANISM	SOLENOID
MAXIMUM FLOW RATE	2.0 GALLONS/MIN AT 50 PSI

INCLUDED COMPONENTS:

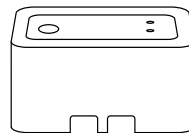

LEAK DETECTOR

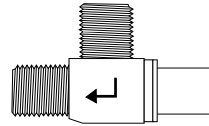

SHUT-OFF VALVE

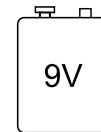

BATTERY

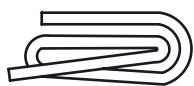

36" OF 3/8" TUBE

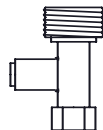

TEE



3/8" PUSH FIT
ADAPTER (x2)



7/16" UNS
FEMALE
ADAPTER



9/16" UNEF
FEMALE
ADAPTER



9/16" UNEF
MALE
ADAPTER

WARRANTY

FOR WARRANTY INFO PLEASE VISIT WWW.MOUNTAINPLUMBING.COM/PAGE/RESOURCES/WARRANTY

FINISH CARE & MAINTENANCE

NEVER USE ANY HARSH ALKALI, ACID BASED DETERGENTS OR CLEANERS SUCH AS SOFT SCRUB®, SCRUBBING BUBBLES® OR COMET® TO CLEAN. DO NOT USE BRILLO® OR SCOTCH BRITE® PADS. THESE WILL ALL HARM THE FINISH. TO CLEAN, USE ONLY A DAMP SOFT CLOTH AND WIPE GENTLY. STANDARD WINDEX® CAN ALSO BE USED SPARINGLY. IT IS NOT NECESSARY TO WIPE HARD TO REMOVE SPOTS. TO MAINTAIN THE FINISH, WIPE WITH A SOFT DRY CLOTH AFTER USE. AN OCCASIONAL COAT OF PURE CARNAUBA WAX WITHOUT CLEANERS WILL HELP PROTECT THE FINISH.

SPECIFICATIONS SUBJECT TO CHANGE WITHOUT NOTICE

www.mountainplumbing.com 972-456-3273 fax 972-456-2719